

# Instantaneous water heater CFX-U



Fully electronically controlled undersink instantaneous water heater in compact size with wireless remote control for energy efficient hot water supply at a kitchen sink. The power consumption is controlled by the electronic in accordance with the ambient temperature and flow rate in order to obtain precisely the set outlet temperature and to keep it constant. The outlet temperature can be set between 20 °C and 60 °C. Two individual temperatures can be memorized and recalled with two program buttons.



## Description

- Fully electronically controlled instantaneous water heater in compact size for undersink installation
- Energy efficient appliance to heat water without any heat losses
- Precise temperatures due to TWIN TEMPERATURE control TTC® up to the capacity of the appliance
- Temperature setting between 20 °C and 60 °C via remote control
- Compatible with solar heating systems
- Easy installation under the kitchen sink due to small dimensions and outside 3/8" water connections for closed-outlet or open-outlet installation
- With power cable for 3-phase power supply
- Multiple Power System MPS®: Power rating can be limited to 11 kW when installing the heater



## Remote control

- Wireless remote control with LCD display for precise temperature setting between 20 °C and 60 °C
- Two program buttons for individual set values, activation of temperature lock as well as indication of function and service menu

## Use



- kitchen sink
- wash basin

Installation is made directly at the connection pipes of the tap.

## Accessories

### LAB 2 (art. no. 82265)

Load shedding relay for combined connection of the water heater and the electric cooker (if no direct power connection is available)

Type	CFX-U FUNKTRONIC MPS®	
Article No.	26313	
Content; design (nominal pressure)	0.3 litres; closed-outlet <sup>1</sup> (10 bar / 1MPa)	
Heating system	bare wire heating system IES®	
Required specific water resistance	≥ 1000 Ωcm at 15 °C	
Min. – max. flow rate	2.0 – 5.0 <sup>2</sup> l/min	
Power rating at 3/PE 400 V 3~	11 kW	13.5 kW
Rated current	16 A	19.5 A
Min. required cable size	1.5 mm <sup>2</sup>	2.5 mm <sup>2</sup>
Hot water flow rate <sup>M</sup> at Δt = 33 K (from 12 °C to 45 °C)	4.8 l/min	5.8 l/min
Temperature range	20 °C bis 60 °C	
Maximum inlet temperature	70 °C	
Weight filled with water	2.2 kg	
Type of protection, safety mark	IP24	 

<sup>1</sup> Appropriate for open-outlet installation

<sup>2</sup> Flow limited in order to obtain optimal temperature increase

<sup>M</sup> Mixed water

## Sample text for specification

Delivery and installation of ... pcs. fully electronically controlled instantaneous water heaters for precise hot water supply between 20 °C and 60 °C, with remote control, Type CFX-U FUNKTRONIC MPS®, power rating ... kW 3/PE 400 V~, supply and installation, programming the heater and putting into operation.

# Instantaneous water heater CFX-U

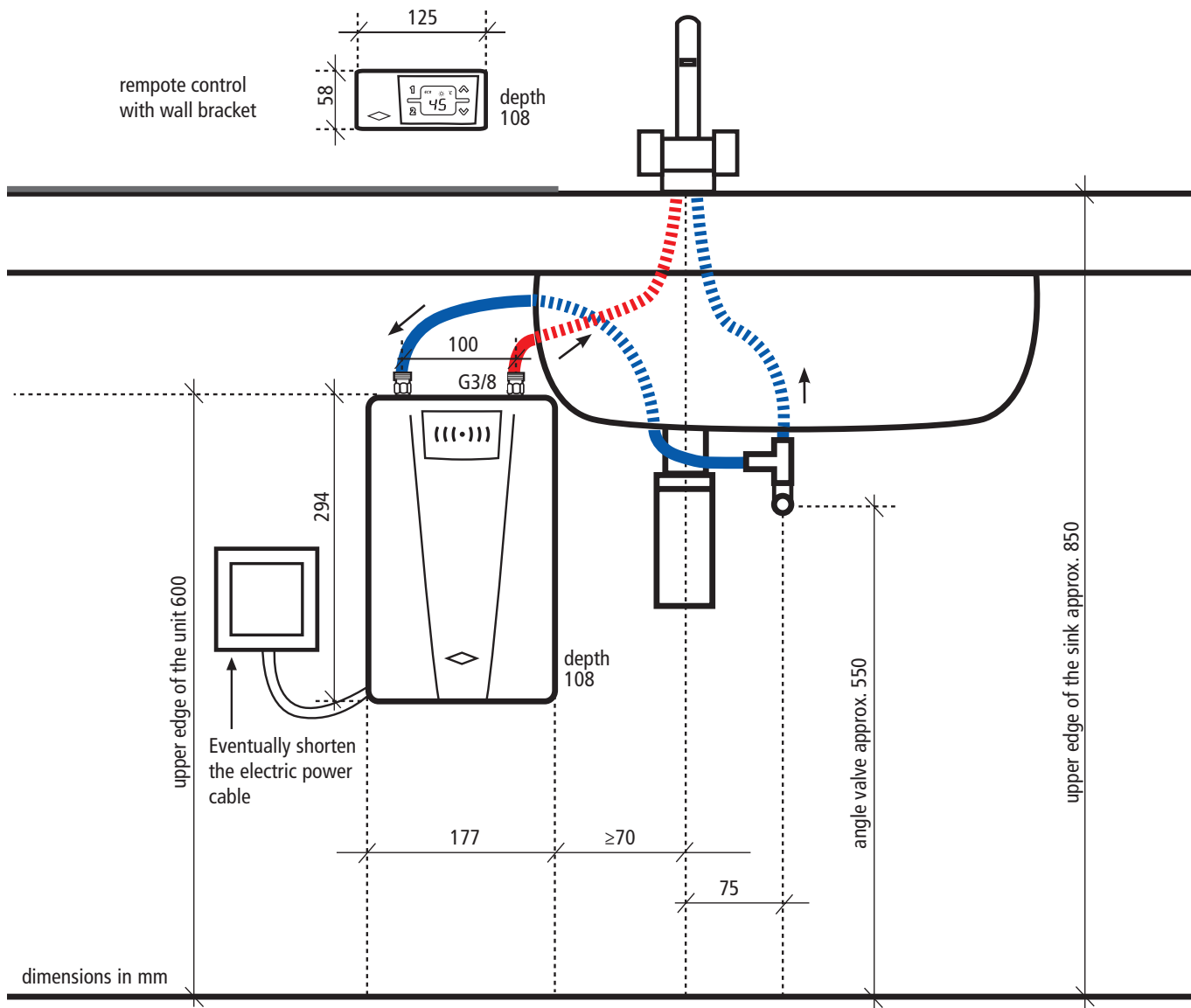

**Example of a closed-outlet installation**

Assembly and operating instructions are to be observed upon installation.

## alternative

**Example of an open-outlet installation with special tap.**

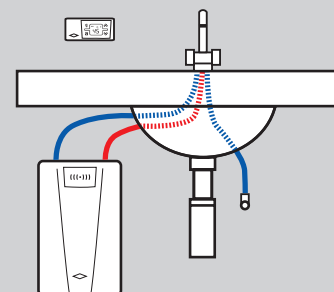

**Installation with load shedding relay LAB (if no direct connection to electricity is possible).**

